

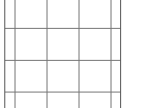

-  Vidrio fotovoltaico
-  Concreto
-  Tierra
-  Acero

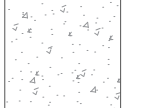

D1
01 Detalle Muro contención
Escala 1:25

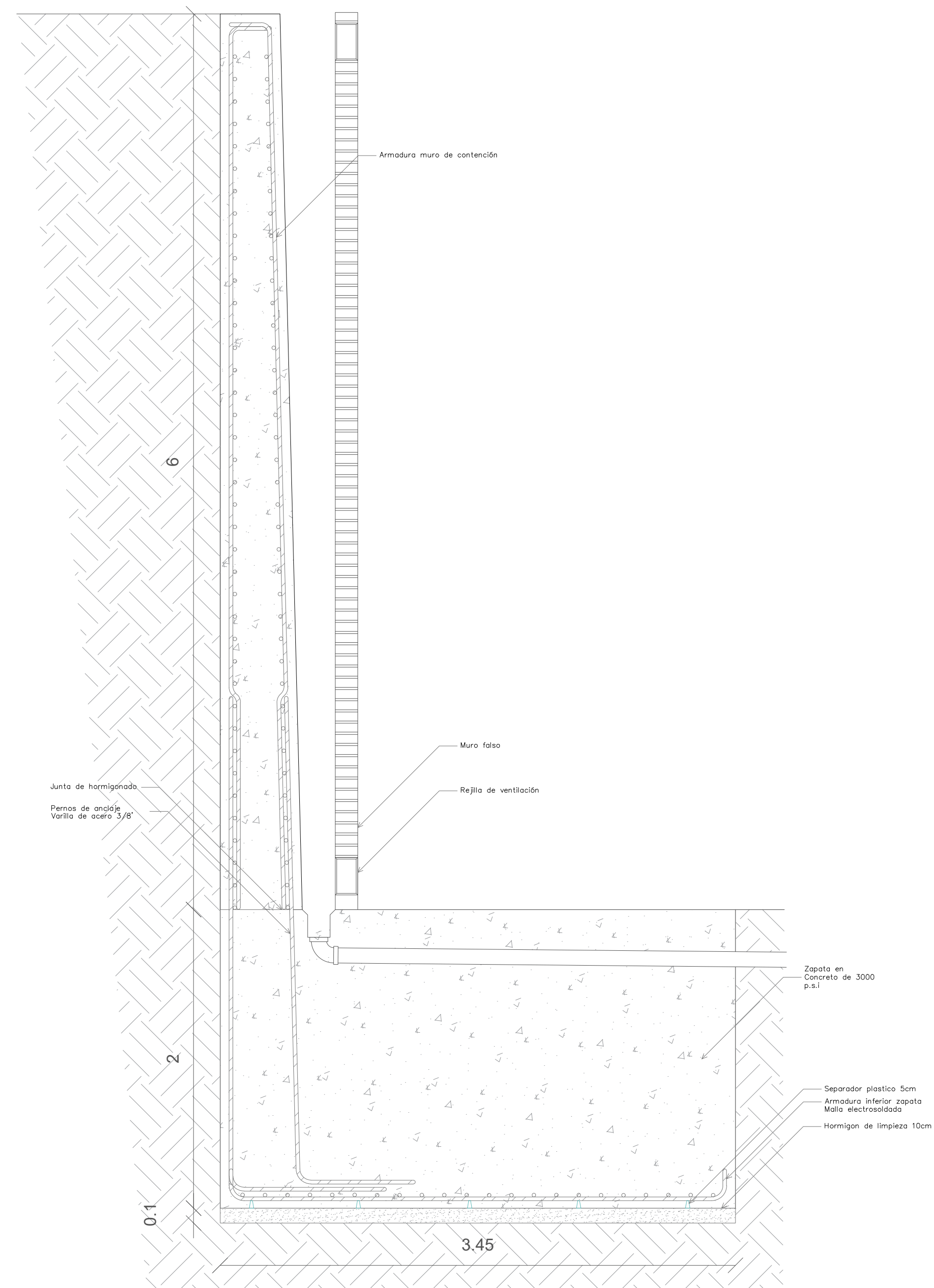
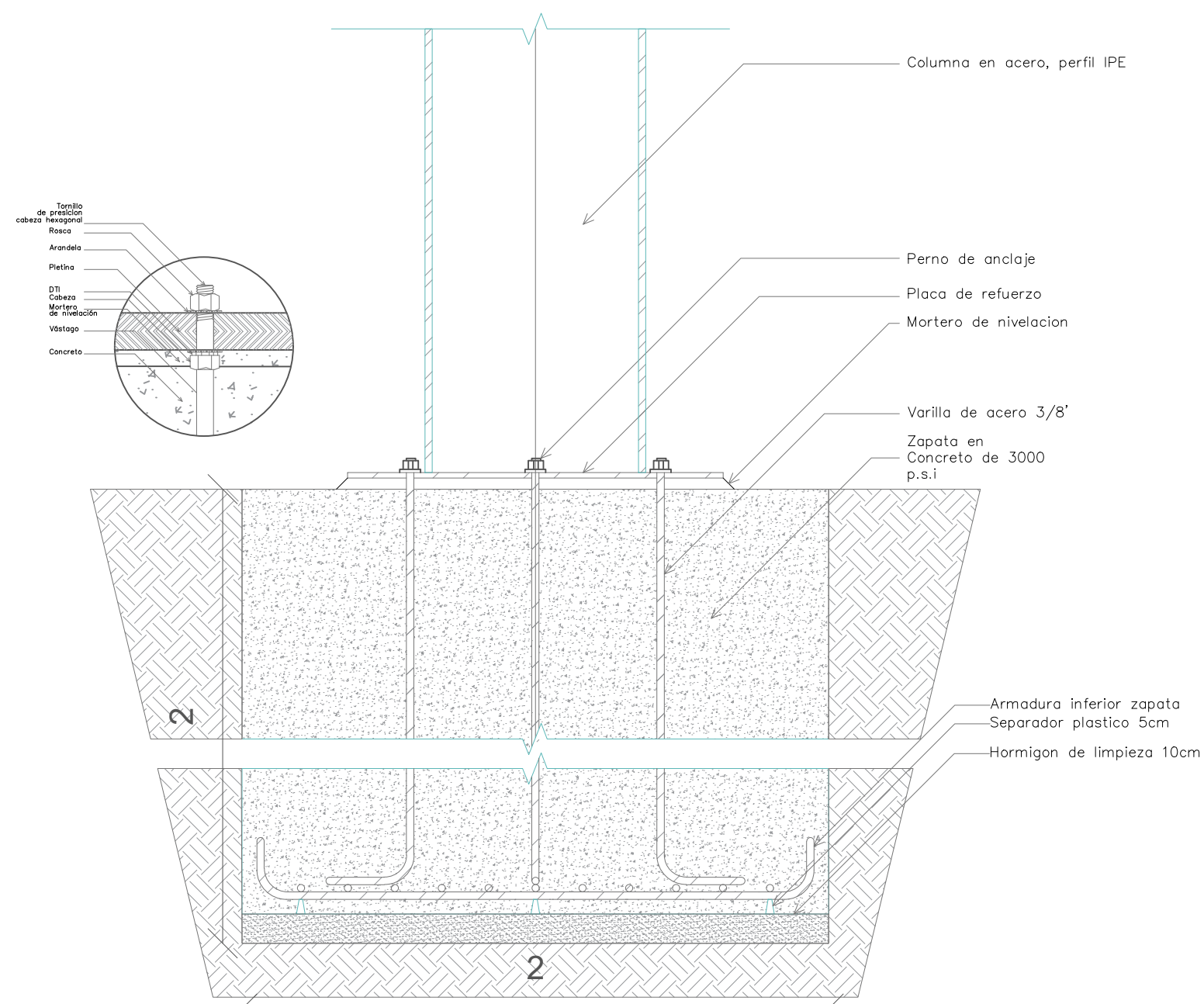

D2
02 Detalle columna-zapata est. metálica
Escala 1:20

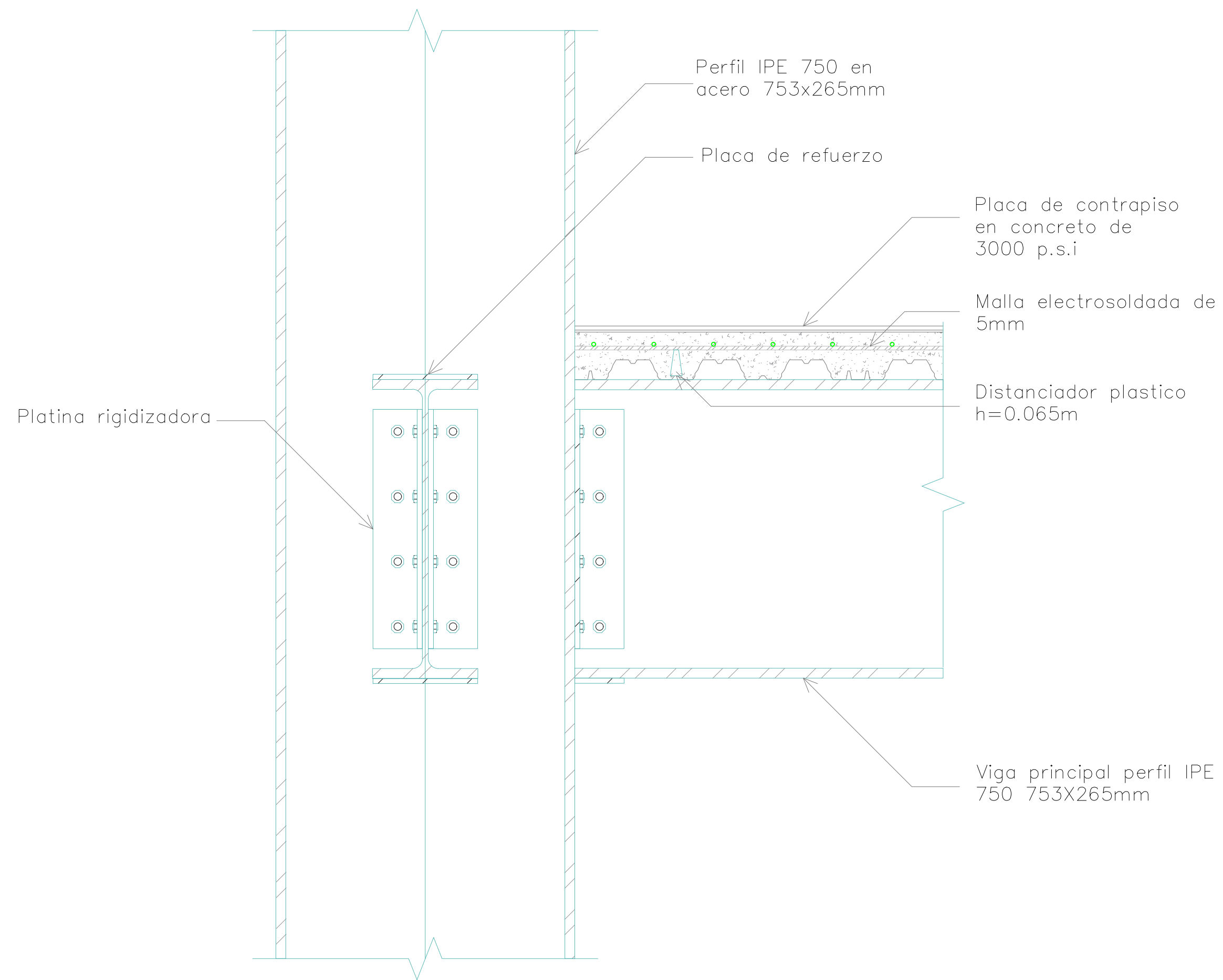

D3
03 Detalle corte placa-columna metálica
Escala 1:10

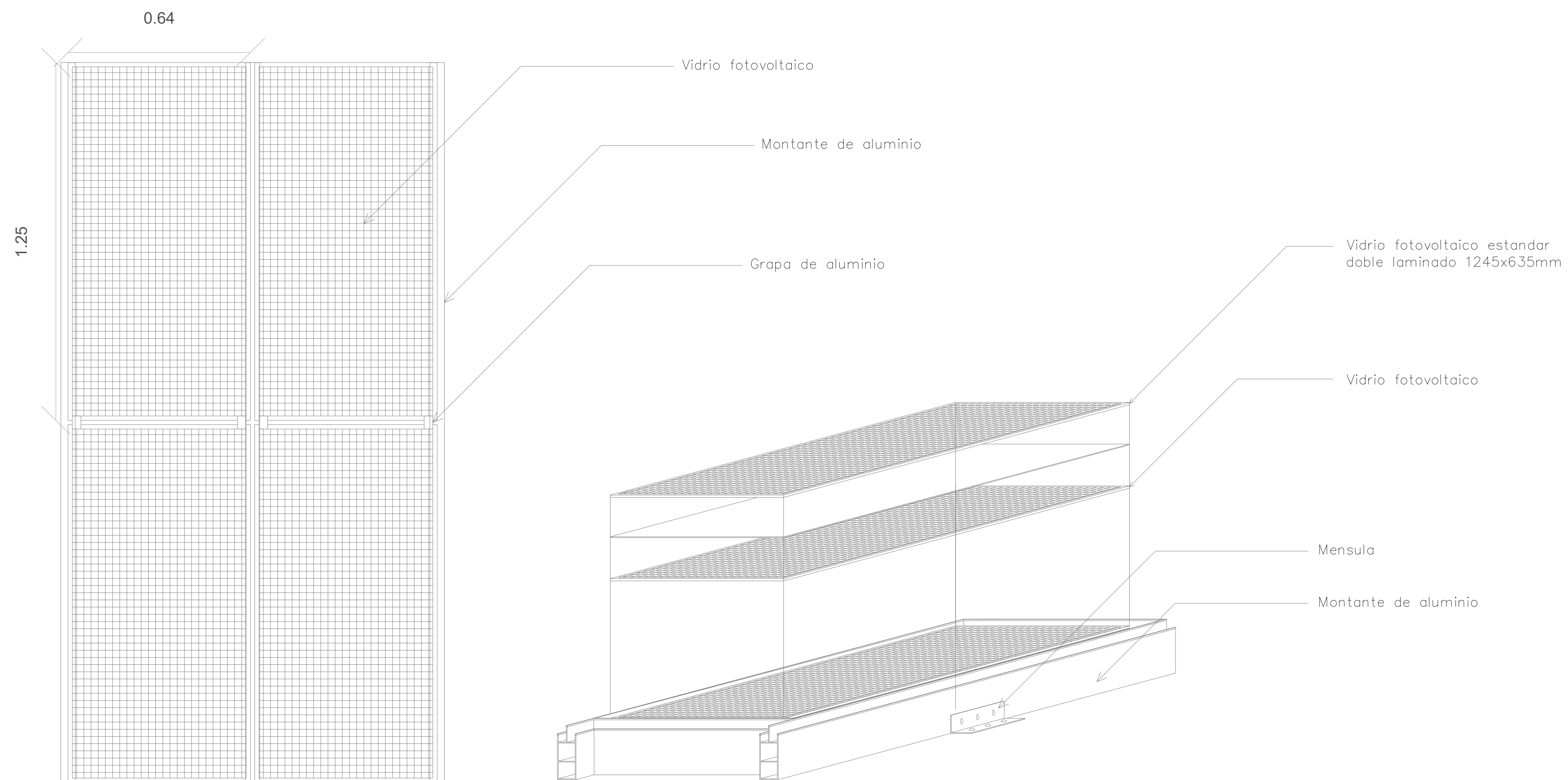

D4
04 Detalle vidrio fotovoltaico
Escala 1:10